



MULTI-INSTALLATIONS[®]

Manufacturers & Installers of High Security Doors & Locks • Kitchen & Bathroom Refurbishment

*Specialist Manufacturer & Installer
of Crime Prevention Products.*

Residential Security **Doors**

Controlled Access **Doors**

High Security **Doors**



WELCOME TO MULTI-INSTALLATIONS LTD.

Our Senior Management and technical staff have over 20 years experience in physical crime prevention measures for high crime estates and commercial applications.

We are now one of the leading companies in this specialized field and the only one to offer the full services of Design, Manufacture and Installation. We are able to offer a comprehensive “one stop” service to clients who insist on a quality products and reliable services.

Our residential security door sets have been tested and certified to the latest Police “Door set tested for PAS 24:2016 and are available in various design configurations.

Access control system doors and screens are designed and built to order and are available in both hardwood and steel constructions.

Our technical design team is available for consultation with architects, building contractors and end users.

Please call us - Today for a FREE no obligation quotation.

***Specialist Manufacturer
& Installer of Crime
Prevention Products.***

Anti-Vandal Front Entrance Doors

Communal Entrance Doors

Jansen Fire Rated Door and Screen

Utility Doors



Anti-Vandal Front Entrance Doors

» Hardwood Laminated Doors with Hardwood Frame

Many Local Authority and Housing Association estates suffer from high crime levels; in particular from violent breaking and entering attacks on individual dwellings which often damage the door and frame beyond repair. It is no longer enough to simply fit an additional lock or bolt to provide protection against this most frightening type of crime.

Developed from years of experience of estate crime, these residential door sets are constructed from pressure bonded hardwood block and are fitted with the renowned Mul-T-Lock for maximum resistance to leverage and impact.

Attractive to look at, with a wide choice of decorative treatments, the doors also contribute to visual appeal in general refurbishment projects.



Prime Features

1. The standard door is constructed using three layers of hardwood block arranged in brick bond format for maximum strength and can be faced with a choice of veneers suitable for stain/varnish and paint finishes.
2. Decorative panels can be provided if desired and a range of vision panel styles are available with suitable anti-vandal glazing materials.
3. All doors are made from half hour fire resistant panels and are available with fitted intumescent strips where necessary.
4. All timber used in the production of door sets is sourced from sustainably managed forest reserves.

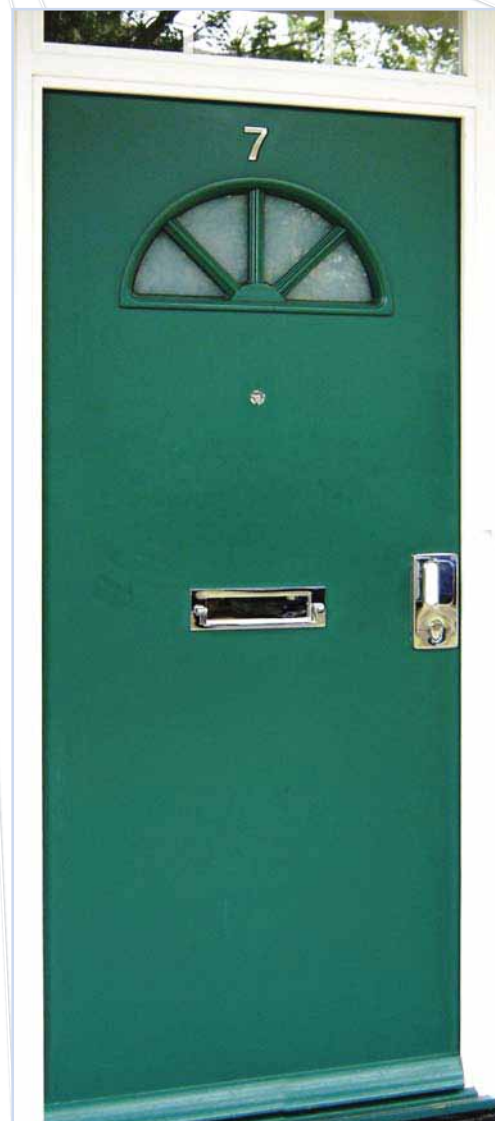

The Advantage of Multipoint Locking



Single Point Locking



Multi Point Locking

Conventional mid-point locking allows the door to be used as a lever against its weakest point i.e. where the door substance has been reduced to accommodate a mortice lock. Multiple bolting locks eliminate this weakness by prevention leverage from 'bending' the door and by spreading impact forces caused by an attack.

Anti-Vandal Front Entrance Doors

» Hardwood Laminated Doors with Hardwood Frame

Sample Specification

- ❖ Carefully take off the existing entrance door, remove any fittings or furniture required by the occupant and hand back.
- ❖ Clean up existing timber frame and remove any fittings in readiness to receive frame armour profiles. Resecure existing frame using 4-No. expanding masonry bolts per jamb. Clear up and dispose of all waste material.
- ❖ Supply and fit steel frame armour profiles and adjust to ensure that the new opening is true and square, and that the correct interlock is present at the junctions of jambs and head.
- ❖ Supply and fit trilaminate security door complete with the following:
 - Adjustable hinge block assemblies to set correct closer gap and alignment.
 - Hinge bolts.
 - Multiple bolting lock mechanism with internal thumbturn operation (to facilitate emergency exit in case of fire) or provide key operation both sides if so instructed by client.
 - Overhead Door Closer (if required).
 - Wide angle viewer or vision panel at clients choice.
 - Letter plate with internal cowl.
 - Numeral plate.
 - Pull handles.
 - Security chain or door check.
 - Perimeter draught seal.
 - External weatherboard where applicable.
- ❖ Instruct occupant in the use and care of the security door.

Notes: If full frame replacement is necessary, the option exists for machine rebated hardwood or welded stainless steel tubular frame sets. Various decorative simulated designs can be provided to enhance the door appearance.



Typical Construction of trilaminate door, showing the three layers of hardwood strips arranged in brick bond format for maximum strength and durability.

Anti-Vandal Front Entrance Doors

» Hardwood Laminated Doors with Frame Armour

A frequent problem encountered on bulk door replacement schemes is the possible damage to internal decorations and finishes which can result from the removal of an existing door frame and the installation of a new frame set. Such damage is often unavoidable and can lead to claims being made by the tenant against the Housing Authority.

Protection of the existing frame with special steel profiles (powder coated in white or to colour choice) can be used in the vast majority of cases to upgrade the original frame to a standard suitable for the fitting of high security doors and lock systems.

Should any original frames be badly damaged or otherwise unsuitable for re-use, then total replacement will of course be necessary. This may take the form of a simple sub-frame plus armour cladding, or full frame replacement in hardwood or steel.

Prime Features

1. Frame armour cladding can remove the need for full frame replacement thereby reducing costs and avoiding the risk of damage claims arising during the contract.
2. Total installation time is reduced to 3-4 hours thus minimising inconvenience to the tenant and ensuring that the dwelling is secured in the shortest possible time.
3. The design of the armour cladding system enables the correction of any 'out of square' frames and allows opening sizes to be regulated so that all doors can be mass-produced without regard to minor size variations which commonly occur.
4. A further benefit is that by eliminating the need for on site setting up, the security doors can be factory pre-finished under controlled conditions for the best results.
5. Because the armour is made in two sections to each jamb and the head, external attack will not dislodge the primary armour section and the interlocking nature assists dissipation of impact load forces over the whole frame.
6. The armour incorporates mountings for adjustable hinges which make it impossible to split the hinge from the frame. The special hinges provide for three way adjustment to set the correct closure gap and alignment.
7. Frame armour profiles are formed from zinc coated mild steel sections which are stove enamelled/powder coated in a white gloss or textured finish. Other colours are available subject to quantity and a relative additional cost.

Secured by Design



Official Police Security Initiative

Police Preferred Specification

Junction of frame jamb and cill section

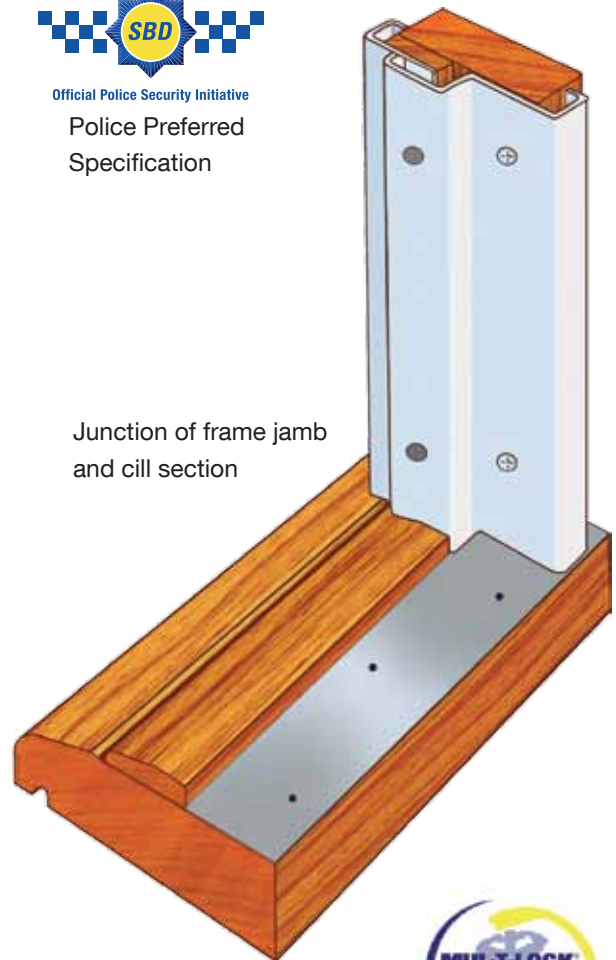

Authorised Dealer



MULTI-INSTALLATIONS[®]
Manufacturers & Installers of High Security Doors & Locks • Kitchen & Bathroom Refurbishment

Tel: 0208 731 1212
E-mail: info@multi1.co.uk, www.multi1.co.uk

Anti-Vandal Front Entrance Doors

» Hardwood Laminated Doors with Frame Armour

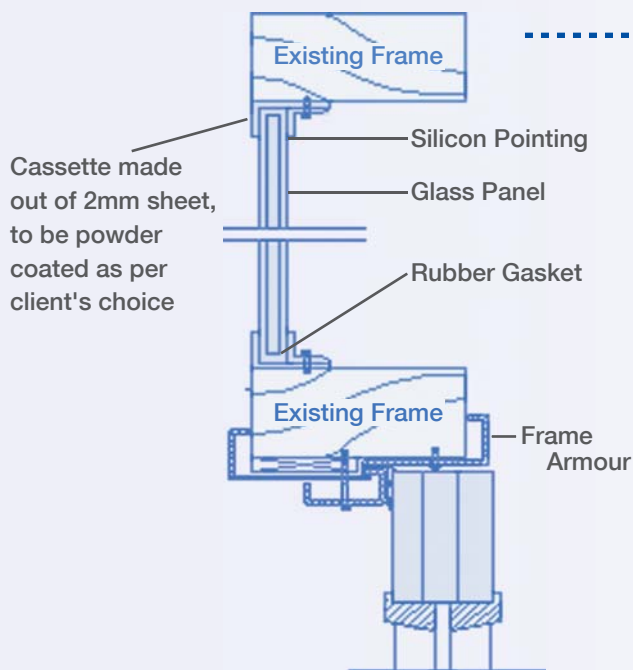

Sample Specification

1. Prepare existing frame by removing any planted on door stops, architraves, and beading. Re-secure door frame using 4-No. expanding masonry bolts per jamb and ensure that the frame is secured and plumb.
2. Frame armour profiles are to be formed from 16 gauge (1.5mm) galvanised mild steel and shall incorporate 18mm door stops formed in the profile together with return flanges to protect the timber frame edges.
3. The head sections are to be square cut at each end and the jamb sections are to be slotted to provide an overlapping fit at the junctions between jambs and head.
4. The jamb sections are to incorporate pre-drilled positions for the hinge blocks, hinge bolts and the lock mechanism.
5. Provide 3-No. hardened steel hinge blocks threaded to accept M10 adjustable hinge connectors fitting into the frame armour via threaded inserts to enable three way adjustments.
6. Screw fixing holes in the steel profiles are to be punch countersunk at approximately 250mm centres and positioned to be covered by the door when closed.

» Hardwood Laminated Doors with Plant-on Moulding

For enquiry, please tick your desire door from below list and email us on: info@multi1.co.uk of this page for further communication.

Your Name : _____

Company Name : _____

Contact no. : _____

Any BS no. : _____ OR RAL no. : _____



MIL 1



MIL 2



MIL 3



MIL 4



MIL 5



MIL 6



MIL 7



MIL 8



MIL 9



MIL 10



MIL 11



MIL 12



MIL 13



MIL 14



MIL 15



MIL 16



MIL 17



MIL 18



MIL 19



MIL 20

Anti-Vandal Front Entrance Doors

» Hardwood Laminated Doors with Plant-on Moulding

Features

- 44mm thick tri-laminate Anti-Vandal door blank
- Door set tested for PAS 24:2016
- All doorsets are FD30 (30 minute fire integrity)
- Hardwood lipped
- Traditionally manufactured for maximum strength and durability
- Complies with Part M regulations for wheelchair access
- Weather proofed and draught proofed
- Custom designs on request

Specification

❖ Sizes:

- Any Size made to order
(however max. size of door leaf will be 1.2m (w) x 2.4m (h))

❖ Ironmongery:

- 3 point locking (Mul-T-Lock ML240 or ML235) with euro profile cylinder and internal thumbturn operation (to facilitate emergency exit in case of fire) or provide key operation both sides if so instructed by client
- 5 no. Mul-T-Lock keys and 1 no. Keycard
- 8mm continuous hinge onto new hardwood frame
OR
- 3-no. adjustable hinge block on frame armour cladding with hinge bolts, onto existing hardwood or softwood frame
- Pull handle

❖ Alternative Frames:

- Steel frame armour profiles (Fit onto existing timber frame)
- 70x95mm rebated hardwood frame
- 80x40x2mm stainless steel hollow section

❖ Hardware:

- Perko type door closer
- Door numeral
- Letter plate with internal security cowl
- Wide-angle viewer
- Security chain
- Perimeter draught seal

❖ Options:

- Solid hardwood cill
- Low line thresh strip for wheelchair access
- External weatherboard (if required)
- Fanlights and sidelights

❖ Finishes:

- Sikkens painted or stained



» Hardwood Laminated Doors with Vision Panel

For enquiry, please tick your desire door from below list and email us on: info@multi1.co.uk of this page for further communication.

Your Name : _____

Company Name : _____

Contact no. : _____

Any BS no. : _____ OR RAL no. : _____



MIL 31



MIL 32



MIL 33

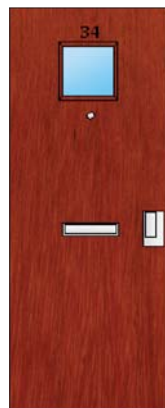

MIL 34



MIL 35



MIL 36



MIL 37



MIL 38



MIL 39



MIL 40



MIL 41



MIL 42



MIL 43



MIL 44



MIL 45



MIL 46



MIL 47



MIL 48

Anti-Vandal Front Entrance Doors

» Hardwood Laminated Doors with Vision Panel

Features

- 44mm thick tri-laminate Anti-Vandal door blank
- Door set tested for PAS 24:2016
- All doorsets are FD30 (30 minute fire integrity)
- Hardwood lipped
- Traditionally manufactured for maximum strength and durability
- Complies with Part M regulations for wheelchair access
- Weather proofed and draught proofed
- Custom designs on request

Specification

❖ Sizes:

- Any Size made to order
(however max. size of door leaf will be 1.2m (w) x 2.4m (h))

❖ Ironmongery:

- 3 point locking (Mul-T-Lock ML240 or ML235) with euro profile cylinder and internal thumbturn operation (to facilitate emergency exit in case of fire) or provide key operation both sides if so instructed by client
- 5 no. Mul-T-Lock keys and 1 no. Keycard
- 8mm continuous hinge onto new hardwood frame OR
- 3-no. adjustable hinge block on frame armour cladding with hinge bolts, onto existing hardwood or softwood frame
- Pull handle

❖ Alternative Frames:

- Steel frame armour profiles
(Fit onto existing timber frame)
- 70x95mm rebated hardwood frame
- 80x40x2mm stainless steel hollow section

❖ Alternative Glazing:

- Pyroshield georgian wire glass
- Clear laminated glass
- Obscure glass
- Double glazed sealed unit

❖ Hardware:

- Perko type door closer
- Door numeral
- Letter plate with internal security cowl
- Wide-angle viewer
- Security chain
- Perimeter draught seal



❖ Options:

- Solid hardwood cill
- Low line thresh strip for wheelchair access
- External weatherboard (if required)
- Fanlights and sidelights
- Various glazing choices

❖ Finishes:

- Sikkens painted or stained

» Hardwood Laminated Doors with Plant-on Moulding with Vision Panel

For enquiry, please tick your desire door from below list and email us on: info@multi1.co.uk of this page for further communication.

Your Name : _____

Company Name : _____

Contact no. : _____

Any BS no. : _____ OR RAL no. : _____



MIL 61



MIL 62



MIL 63



MIL 64



MIL 65



MIL 66



MIL 67



MIL 68



MIL 69



MIL 70



MIL 71



MIL 72



MIL 73



MIL 74



MIL 75



MIL 76



MIL 77



MIL 78



MIL 79



MIL 80



MIL 81

» Hardwood Laminated Doors with Plant-on Moulding with Vision Panel



MIL 82



MIL 83



MIL 84



MIL 85



MIL 86



MIL 87

Features

- 44mm thick tri-laminate Anti-Vandal door blank
- Door set tested for PAS 24:2016
- All doorsets are FD30 (30 minute fire integrity)
- Hardwood lipped
- Traditionally manufactured for maximum strength and durability
- Complies with Part M regulations for wheelchair access
- Weather proofed and draught proofed
- Custom designs on request

Specification

❖ Sizes:

- Any size made to order
(however max. size of door leaf will be 1.2m (w) x 2.4m (h))

❖ Ironmongery:

- 3 point locking (Mul-T-Lock ML240 or ML235) with euro profile cylinder and internal thumbturn operation (to facilitate emergency exit in case of fire) or provide key operation both sides if so instructed by client
- 5 no. Mul-T-Lock keys and 1 no. Keycard
- 8mm continuous hinge onto new hardwood frame OR
- 3-no. adjustable hinge block on frame armour cladding with hinge bolts, onto existing hardwood or softwood frame
- Pull handle

❖ Alternative Frames:

- Steel frame armour profiles
(Fit onto existing timber frame)
- 70x95mm rebated hardwood frame
- 80x40x2mm stainless steel hollow section



❖ Alternative Glazing:

- Pyroshield georgian wire glass
- Clear laminated glass
- Obscure glass
- Double glazed sealed unit

❖ Hardware:

- Perko type door closer
- Door numeral
- Letter plate with internal security cowl
- Wide-angle viewer
- Security chain
- Perimeter draught seal

❖ Options:

- Solid hardwood cill
- Low line thresh strip for wheelchair access
- External weatherboard
(if required)
- Fanlights and sidelights
- Various glazing choices

❖ Finishes:

- Sikkens painted or stained

Anti-Vandal Front Entrance Doors

» Completed Projects

A selection of doors from recently completed projects.

All doors have been designed, built and installed by Multi-Installations Ltd.

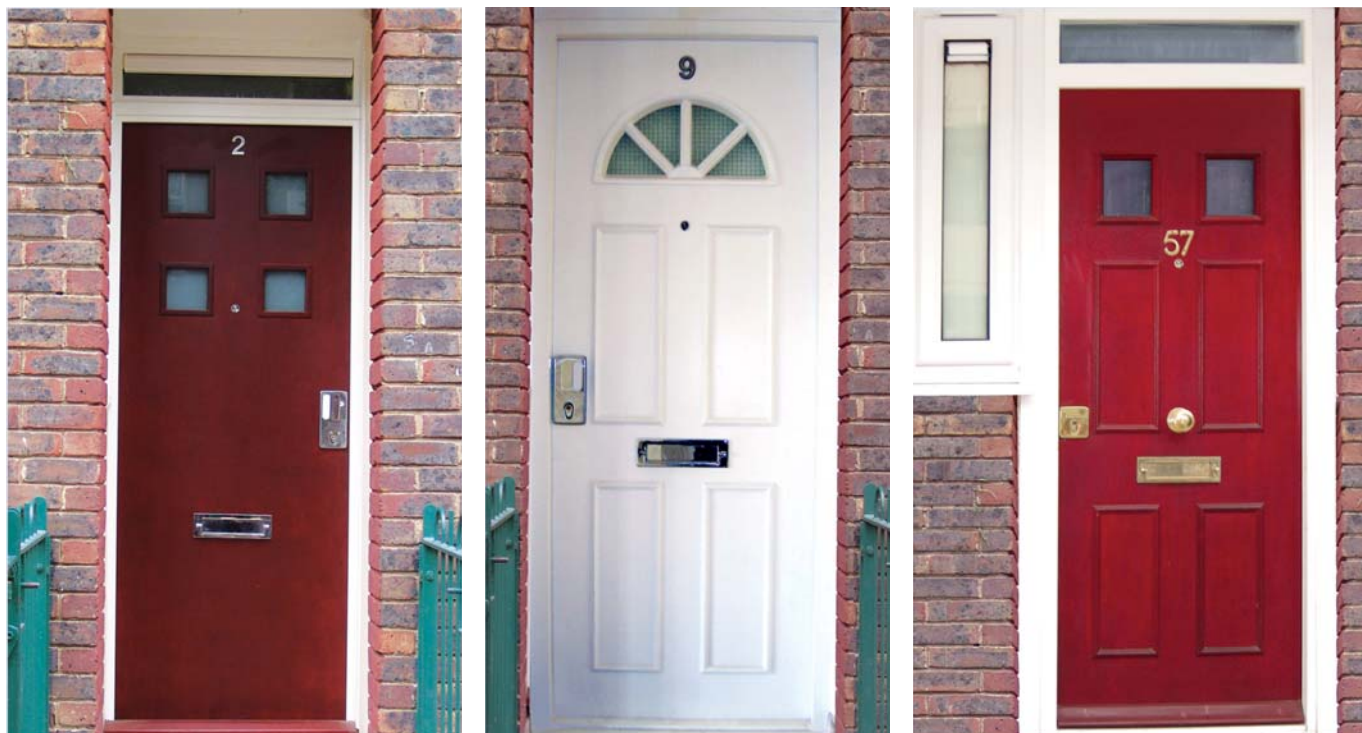

Anti-Vandal Front Entrance Doors

» Completed Projects



Communal Entrance Doors

» Communal Entrance Doors - Options

Estate crime prevention has become a major problem requiring increasingly sophisticated measures which now form an integral part of most refurbishment projects.

At the core of this problem is the ability to limit access to any block of flats to tenants and those with legitimate reason to require entry. This generally requires the creation of a single entry point with a high security door set coupled with electronic access controls and in some cases, CCTV cameras for routine surveillance.

Because of the enormous variety of structures and environments, this has become a highly specialised field requiring an expert design and build approach in order to create individually effective solutions.

Recent years have seen a dramatic rise in the use of both mild and stainless steel constructions because of the strength, durability and largely maintenance free nature of these materials compared to more traditional hardwood structures.

Jansen Steel Door Sets

Tested as per SBD standard

1. The Swiss designed Jansen system of mild steel profiles has many architectural and engineering uses and is particularly well suited to the design and construction of a wide range of communal entrance door and screen applications.
2. The high strength of the Jansen profiles enables the use of attractively slender sections which permit minimum frame bulk and maximum light admission.
3. This fully welded system allows a considerable range of entrance designs and offers compatibility with most architectural themes and requirements. All mild steel elements are zinc sprayed and powder coated with a gloss or textured finish to colour choice.
4. The main frame is normally made with 100 x 50 tubular stainless steel sections, which facilitates the removal and replacement of any damaged Jansen panes.
5. It is not possible to detail the extent of this remarkable system in a single leaflet, but the accompanying photographs will give a reasonable indication. However, we recommend that you meet with one of our technical staff for an in-depth discussion of your particular requirements.

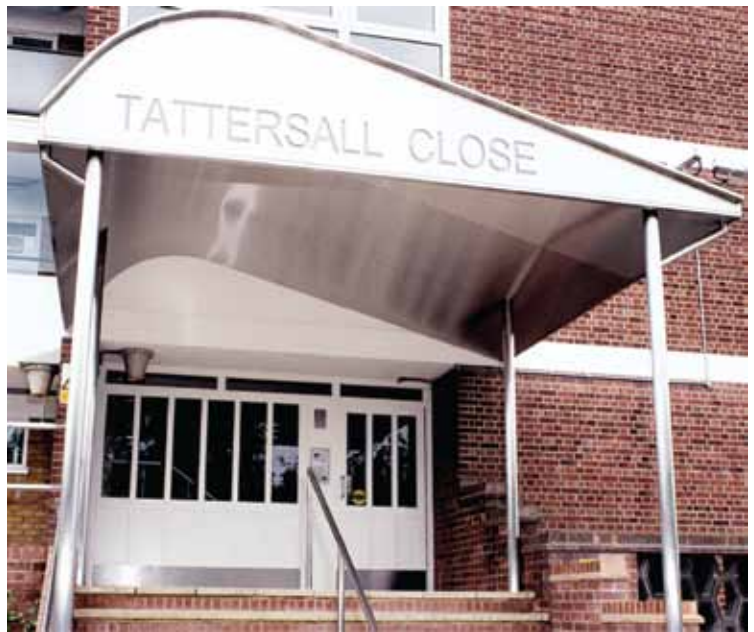

Communal Entrance Doors

» Communal Entrance Doors - Options

Tubular Stainless Steel Doors

1. The standard tubular construction employs a wide range of RHS tubing from 20x20mm through to 100x50mm and allows considerable flexibility of design, whilst providing high strength and corrosion resistance.
2. This welded system is normally supplied in natural satin finish, but can also be powder coated to colour choice in gloss or textured finish.
3. Where solid core doors or panels are required, they can be faced with stainless steel or decorative GRP sheets.
4. Both this and the Jansen system lend themselves to external entrance porch constructions.

Hardwood Portcullis Doors

1. These traditional style door and screen sets are available in conventional mortise and tenon constructions or in a unique 'one piece' design where the glazed apertures are routed into solid core panels with raised muntins applied to each side.
2. Some benefits of using solid core panels are: no problems of matching wood grains and colours on rails and stiles and concealed steel reinforcement bars in the rails increases resistance to attack.
3. All timber used in both types of doors and screens is from sustainable forest reserves.

Standard Features

1. Full height stainless steel hinges in standard or anti-nip configuration.
2. Heavy duty quality surface mounted or concealed door closers.
3. Locking by Assa mortice lock engaging into an electric release, or magnets and armature plates.
4. Stainless steel pull handles and push plates plus kick plates.
5. Full height anti-thrust plates/gap guards according to door construction.
6. Glazing to client preference (normally 11.5mm laminated clear glass)
7. Weather seal thresholds where required.
8. Door stops/restraints if required.
9. Frame fixing at approx. 600mm centres, using expanding masonry bolts or chemical anchors.



High Security Doors

» Hardwood Timber Doors with Stainless Steel Frame

To meet the increasing demand for door protection in circumstances where the door may be subjected to sustained and violent attack, these specially designed door sets are built to order for commercial applications with high value or sensitive material storage areas. They are also invaluable for computer rooms, electrical intake cupboards, lift motor rooms and isolated buildings.

The basis of design is of course to prevent a break in, or at least to delay forced entry for long enough to allow alarm response action. In any event, the increased time scale required to achieve entry is likely to bring about abandonment of the attack for fear of discovery and capture.

Prime Features

1. Two types of door leaf are available:
 - (a) solid core hardwood block in brick bond format, or
 - (b) cross bonded multiple panels from 44mm to 64mm thick
2. Protective facing materials are pressure bonded to both sides of the door and are selected from reinforced or decorative GRP, zinc coated mild steel or stainless steel.
3. Various high security locking systems are available according to requirements and client preferences. The standard lock is a gear driven multiple bolting mechanism which has been well proven over many years in high crime environments. Other options include mortice and surface mounted locks, electric releases or magnetic devices.
4. Note: Where doors may have to be accessed by the Fire Brigade, we can provide a modified version of our gear driven multiple bolting lock which is operated by the Express drop release key carried by Fire Crews.
5. Outward opening doors will be fitted with a full height stainless steel anti-thrust plate on the closing edge of the door, secured through a back plate by anti-vandal machine screws.
6. The frame set is a fully welded stainless steel (RHS) tub construction complete with welded on door stops and a 5mm thick sole plate. The frame finish is either natural or powder coated to colour choice.
7. These high security door sets are available in both single and double configurations and can be designed to incorporate electronic release mechanism and alarm devices.

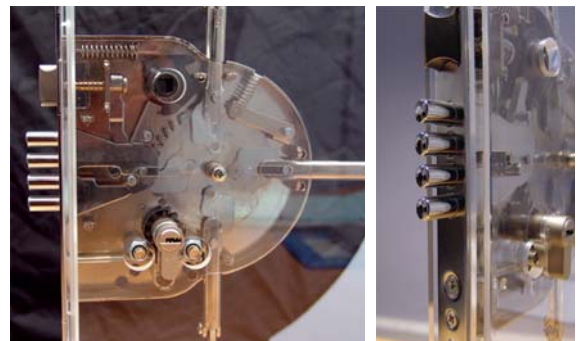

Locking shown is a multi-directional mortice lock which drives 12mm diameter bolt heads into three or all four sides of the frame.



High Security Doors

» Steel Face Timber Doors with Stainless Steel Frame

Sample Specification

1. Supply and fit fully welded stainless steel RHS tubular door frame complete with welded door stops and a 5mm sole plate. The frame to be provided with 4-No. holes in each jamb, plus 2-No. holes in both the transom and sole plate.
2. Securely fasten new frame to surrounding builder's work using expanding masonry bolts or chemical anchors according to requirements.
3. Select and cut to size a solid core/multiple door leaf and machine to receive the locking system before pressure bonding the required protective facing material to each side of the door.
4. Door to be hung on a heavy duty stainless steel continuous hinge fitted with 2-No. hinge bolts.
5. Provide full height stainless steel anti-thrust plate to the leading edge of the door, secured through a back plate using stainless steel anti-vandal machine screws. (Note: this applies only to outward opening doors.)
6. Provide gear driven multi-bolting mechanism within door thickness and equipped with high security cylinder and 5-No. registered keys. (Note: Other locking systems are available to suit specific client requirements.)

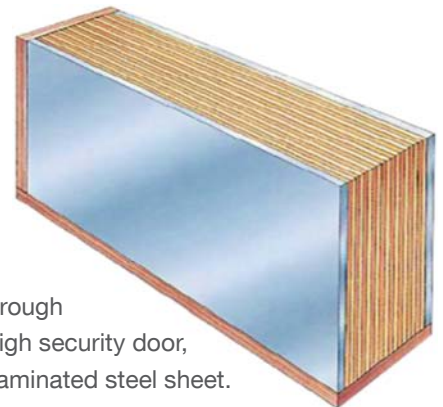

Typical section through multiple high security door, showing laminated steel sheet.

Jansen Steel Doors and Side Screens

For enquiry, please tick your desire door from below list and email us on: info@multi1.co.uk of this page for further communication.

Your Name : _____

Company Name : _____

Contact no. : _____

Any BS no. : _____ OR RAL no. : _____

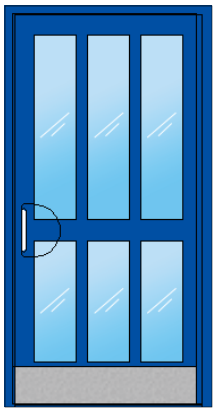

MIL 121

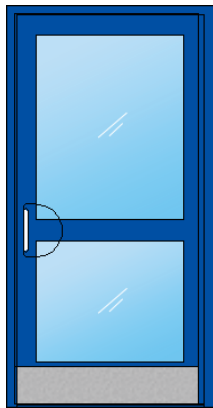

MIL 122

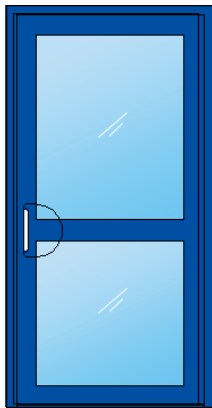

MIL 123

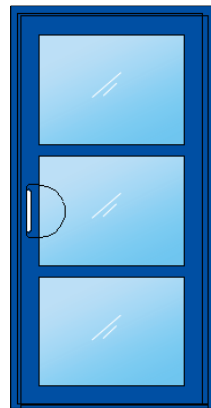

MIL 124

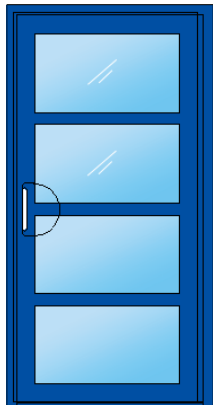

MIL 125

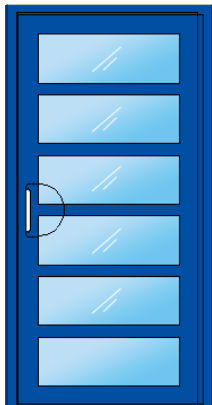

MIL 126

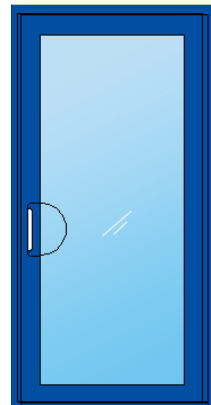

MIL 127



MIL 128



MIL 129



MIL 130

Communal Entrance Doors

Tested as per SBD standard

» Jansen Steel Doors and Side Screens

Features

- All Doors to be manufactured from 2mm thick mild steel Jansen sections, all joints to be welded and ground to smooth finish. Jansen sections to be shot blasted, hot zinc sprayed and polyester powder coated textured finish to any BS or RAL No (All Metallic and certain silver paints at extra cost).
- Complies with Part M regulations for wheelchair access
- Custom designs on request
- One hour fire rated Jansen steel door with side screen available in selected design

Specification

❖ Sizes:

- Any size made to order

❖ Ironmongery:

- 12mm Anti-nip stainless steel continuous hinge
- Stainless steel pull handle 225x22mm
- Stainless steel push plate internal face

❖ Alternative Frames:

- 80x40x2mm stainless steel hollow section
- 100x50x2mm stainless steel hollow section

❖ Alternative Glazing:

- Pyroshield georgian wire glass
- Laminated glass
- Obscure glass
- Double glazed sealed unit

❖ Hardware:

- LCN2035 concealed door closer
- Stainless steel kick plate internal and external

❖ Options:

- Magnalock housing to be manufactured from 60x40x2mm (for M32 magnets) or 100x50x2mm (for M82 magnets) stainless steel hollow section fixed with security screws
- 2-No Magna Locks (Securitron M32 and M32C)
OR
- To meet Secured by design standards
2-No Magna Locks (Securitron M82 and M82C)
- RX100 low level threshold
- Fanlights and sidelights

❖ Finishes:

- Painted - BS or RAL colour

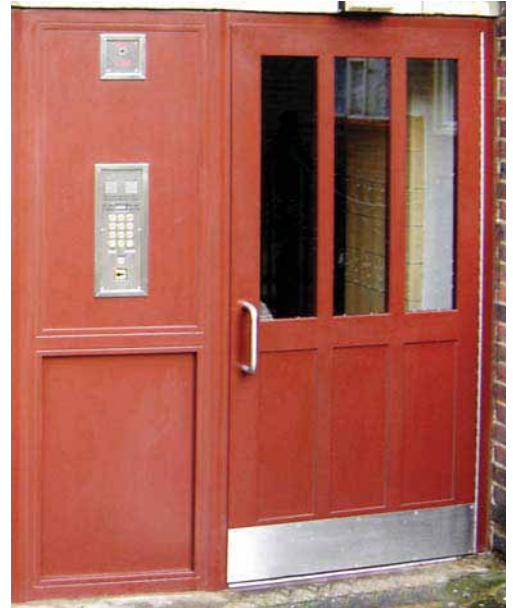

Please Note:

All/any electrical equipment to be disconnected and connected by others.
Electrical equipment supply and connected by others.

» Communal Timber Doors

For enquiry, please tick your desire door from below list and email us on: info@multi1.co.uk of this page for further communication.

Your Name : _____

Company Name : _____

Contact no. : _____

Any BS no. : _____ OR RAL no. : _____



MIL 101

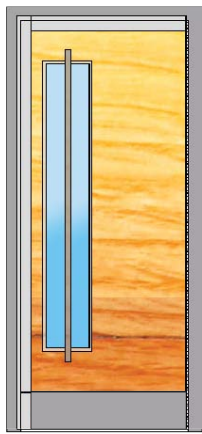

MIL 102

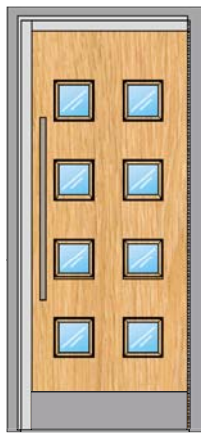

MIL 103

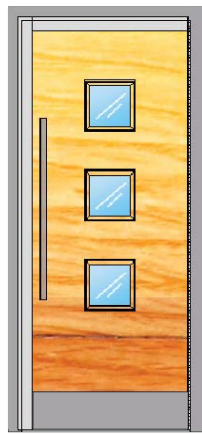

MIL 104

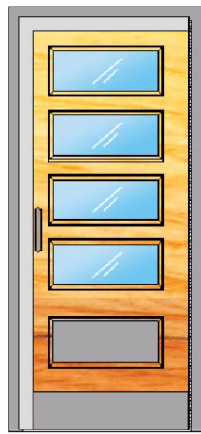

MIL 105

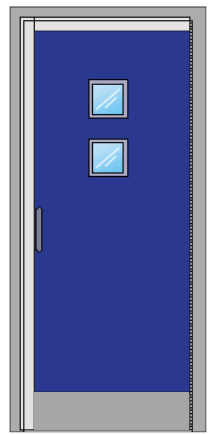

MIL 106

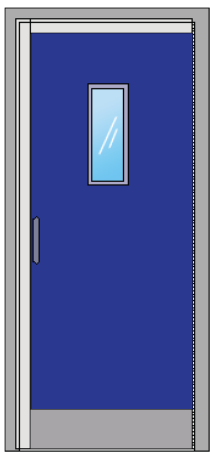

MIL 107

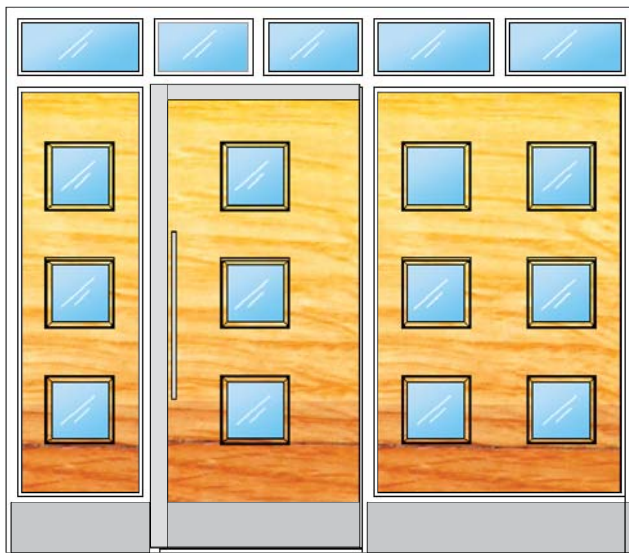

MIL 108

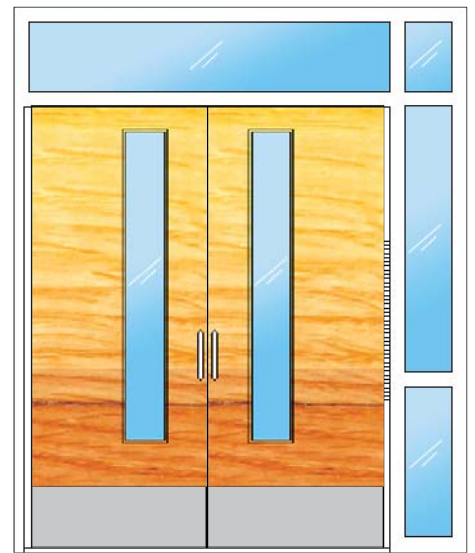

MIL 109

Communal Entrance Doors

» Communal Timber Doors



Features

- 44mm / 54mm thick tri-laminate Anti-Vandal door blank
- Full length gap guard protection to lock
- This traditional style door and screen sets are available in conventional mortise and tenon construction or in a unique 'one piece' design where the glazed apertures are routed into solid core panels with raised muntins applied to each side.
- This traditional style door and screen sets are available in a unique 'one piece' design where the glazed apertures are routed into 44mm solid core panels.
- Complies with Part M regulations for wheelchair access
- Custom designs on request

Specification

- ❖ **Sizes:**
 - Any size made to order (however max. size of door leaf will be 1.2m (w) x 2.4m (h))
- ❖ **Ironmongery:**
 - 12mm stainless steel continuous hinge onto hardwood frame or stainless steel frame
 - Stainless steel pull handle 225x22mm or stainless steel long pull handle
 - Stainless steel push plate
- ❖ **Alternative Frames:**
 - 80x40x2mm stainless steel hollow section
 - 100x50x2mm stainless steel hollow section
 - 70x95mm rebated hardwood frame
- ❖ **Alternative Glazing:**
 - Pyroshield georgian wire glass
 - Laminated glass
 - Obscure glass
 - Double glazed sealed unit
- ❖ **Hardware:**
 - Surface mounted door closer
 - Stainless steel full height gap guard
 - Stainless steel full width gap guard on top
 - Stainless steel kick plate internal and external
- ❖ **Options:**
 - Magnalock housing to be manufactured from 60x40x2mm (for M32 magnets) or 100x50x2mm (for M82 magnets) stainless steel hollow section fixed with security screws
 - Mul-T-Lock, ASSA lock with electric strike
 - Upgrade from surface mounted door closer to an LCN2035 concealed door closer
 - RX100 low level threshold (if required)
 - Fanlights and sidelights
- ❖ **Finishes:**
 - Sikkens painted or stained

Please Note:

All/any electrical equipment to be disconnected and connected by others. Electrical equipment supply and connected by others.

» Jansen Steel Fixed Screen with Glazing & Solid Panel

For enquiry, please tick your desire door from below list and email us on: info@multi1.co.uk of this page for further communication.

Your Name : _____

Company Name : _____

Contact no. : _____

Any BS no. : _____ OR RAL no. : _____

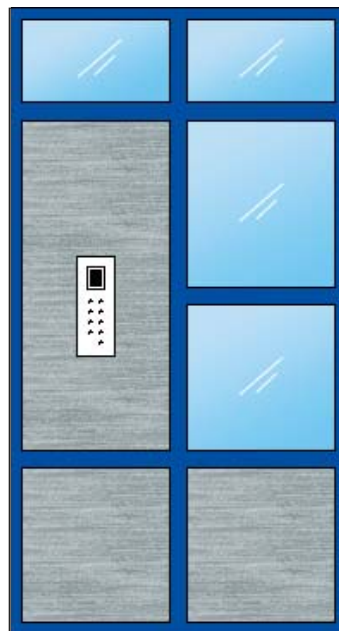
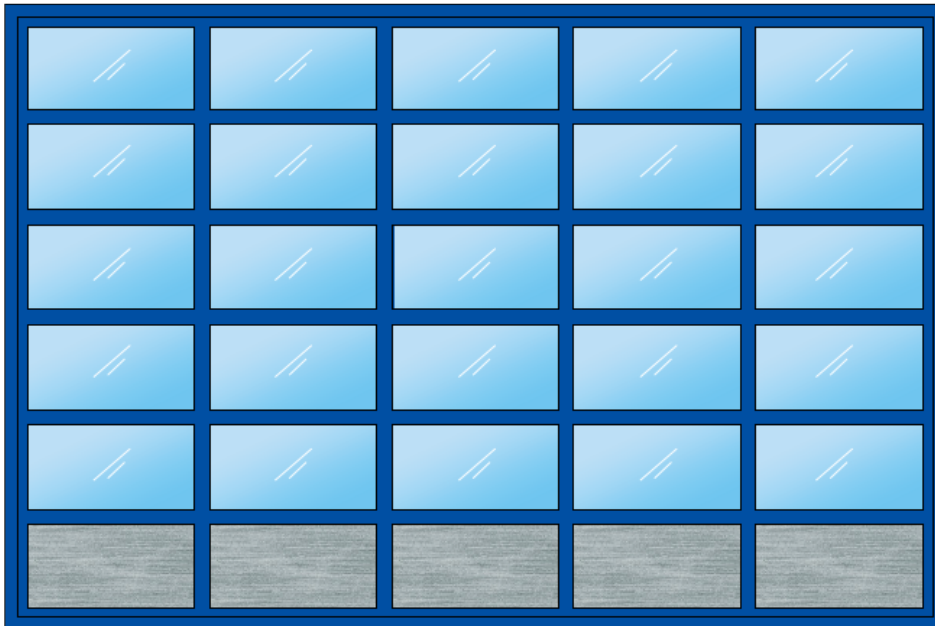

Screens

» Jansen Steel Fixed Screen with Glazing & Solid Panel



Features

- All Jansen steel screen to be manufactured from 2mm thick mild steel Jansen sections, all joints to be welded and ground to smooth finish. Jansen sections to be shot blasted, hot zinc sprayed and polyester powder coated textured finish to any BS or RAL No (All Metallic and certain silver paints at extra cost)
- Custom designs on request

Please Note:

All/any electrical equipment to be disconnected and connected by others. Electrical equipment supply and connected by others.

Specification

- ❖ **Sizes:**
 - Any size made to order
- ❖ **Alternative Frames:**
 - 80x40x2mm stainless steel hollow section
 - 100x50x2mm stainless steel hollow section
 - Jansen Section
- ❖ **Alternative Glazing:**
 - Pyroshield georgian wire glass
 - Laminated glass
 - Obscure glass
 - Double glazed sealed unit
- ❖ **Options:**
 - Fanlights and sidelights
- ❖ **Finishes:**
 - Painted - BS or RAL Colour

Communal Entrance Doors

» Completed Projects

A selection of doors from recently completed projects.
All doors have been designed, built and installed by Multi-Installations Ltd.



Communal Entrance Doors

» Completed Projects



For enquiry, please tick your desire door from below list and email us on: info@multi1.co.uk of this page for further communication.

Your Name : _____

Company Name : _____

Contact no. : _____

Any BS no. : _____ OR RAL no. : _____

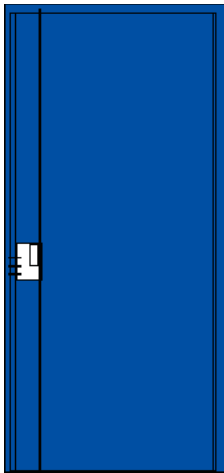

MIL 141

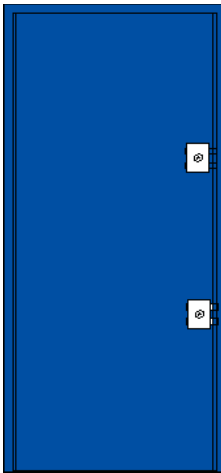

MIL 142

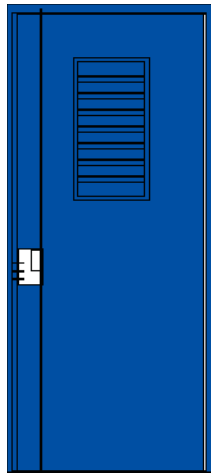

MIL 143

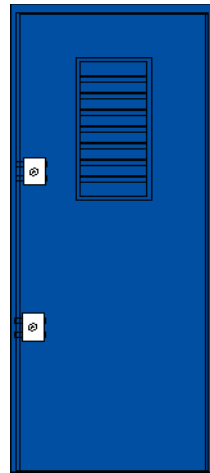

MIL 144

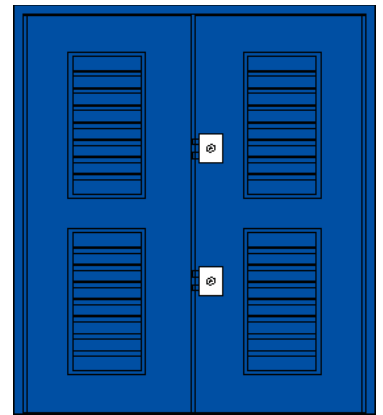

MIL 145

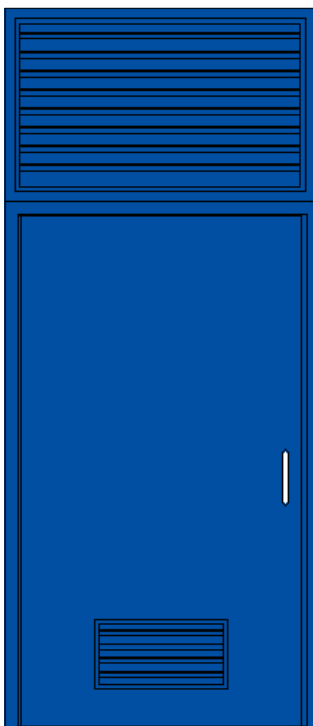

MIL 146

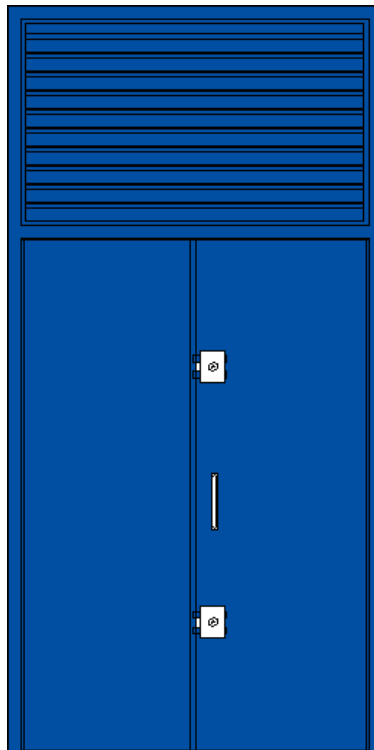

MIL 147

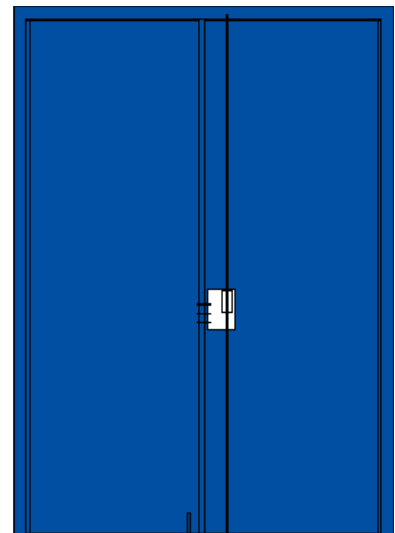

MIL 148

Utility Doors

Features

- 44mm thick tri-laminate door blank laminated with 0.9mm steel sheets both sides
- Door edges to be capped with stainless steel channels on all sides
- All steel on door and frame to be powder coated
- Full length gap guard protection to lock
- Custom designs on request

Specification

❖ Sizes:

- Any size made to order (however max. size of door leaf will be 1.2m (w) x 2.4m (h))

❖ Ironmongery:

- 12mm stainless steel continuous hinge onto hardwood frame or stainless steel frame
- Stainless steel pull handle 225x22mm or stainless steel long pull handle
- Stainless steel push plate
- Barrel Bolts - on passive door (where double door)

❖ Alternative Frames:

- 80x40x2mm stainless steel hollow section
- 100x50x2mm stainless steel hollow section
- 70x95mm rebated hardwood frame

❖ Hardware:

- Surface mounted door closer
- 2mm Stainless steel full height gap guard
- Metal louvre, Mesh
- Weatherboard (where door is exposed to rain)



❖ Options:

- Upgrade from surface mounted door closer to an LCN2035 concealed door closer
- RX100 low level threshold (if required)
- Fanlights (Solid Panel, Mesh or Louvred)

❖ Locking Options:

- Mul-T-lock
- Gerda Lock
- Mortice Lock
- FB1 or FB2 or FB4 Lock

❖ Finishes:

- Painted - BS or RAL colour

Utility Doors



Other Doors



MULTI-INSTALLATIONS LTD

Corporate Office:
27 Victoria Gardens,
Burgess Hill, West Sussex,
RH15 9NB United Kingdom
Tel: 0208 731 1212
E-mail: info@multi1.co.uk
www.multi1.co.uk

